



LSS-TG SERIES Precision Test Pressure Gauge All Stainless Steel



Application

Germany Engineered for demanding applications, the Lomas LSS-TG series Test pressure gauge delivers exceptional precision when measuring and controlling pressure in highly corrosive environments

Key Specification

Nominal sizes

6"

Accuracy

Cl 0.4, Cl 0.25

Connection

BSP 1/2" for 6"

Scale Range, according to EN 837-1/5

- **Pressure ranges:** 0 to
1/1.6/2.5/4/6/10/16/25/40/60/100/160
/250/400/600/1000 bar
- **Vacuum range:** -1 to 0 bar

Operating Temperature

Ambient: -40°C to 60°C, medium: 100°C
maximum

Material Specification

- **Case:** AISI 304 steel case and friction ring
- **Window:** Instrument glass

Additional Options

- NPT, BSPT or other process connection
- Restrictor
- Mirror scale
- Adjustable knob on window



Technical Drawing And Dimensions

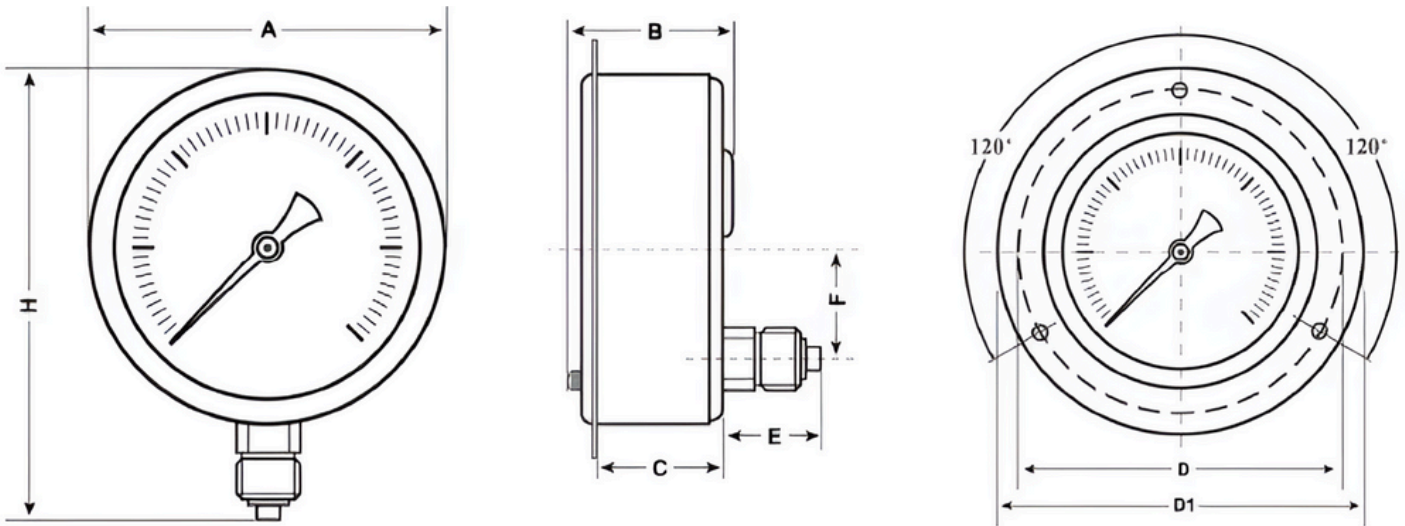

DIAL SIZE	A	B	C	H	D1	D2	E	F
6"	Ø 149	58	39	120	Ø 166	Ø 180	45	47.5

dimensions are approximate and can be changed without prior notice